



I-680/SR 84 INTERCHANGE IMPROVEMENTS AND SR 84 WIDENING PROJECT

SMP 32 PLANT REPLACEMENT PLANS

| | | | | | |
|------|--------|--------|---------------------------|-----------|--------------|
| Dist | COUNTY | ROUTE | POST MILES TOTAL PROJECT | SHEET No. | TOTAL SHEETS |
| 04 | Ala | 84,680 | 17.9/R22.9 R10.3/R15.3 | 954 | |

 LICENSED LANDSCAPE ARCHITECT

 LEAH HAYGOOD
 signature
 8-31-21
 Renewal Date
 Date

PLANS APPROVAL DATE _____

THE STATE OF CALIFORNIA OR ITS OFFICERS OR AGENTS SHALL NOT BE RESPONSIBLE FOR THE ACCURACY OR COMPLETENESS OF SCANNED COPIES OF THIS PLAN SHEET.

| | |
|--|--|
| HAYGOOD AND ASSOCIATES 1496-B Solano Avenue Albany, CA 94706 | ALAMEDA CTC 1111 Broadway Suite 800 Oakland, CA 94607 |
|--|--|

PLANT LEGEND

| PLANT GROUP (SIZE) | PLANT No. | SYMBOL | BOTANICAL NAME | COMMON NAME | HOLE SIZE | | BASIN TYPE | PLANT AREA GROUP F/H/M | WOOD MULCH | APPLICATION RATES ① | | | | MINIMUM PLANTING DISTANCE FROM: | | | | | | REMARKS | |
|--------------------|-----------|--------|--|------------------------------|-----------|-------|------------|------------------------|------------|---------------------|--------------------|--------------------|-------------------|---------------------------------|-----|----|-------|------|-------------|--------------|-------------|
| | | | | | DIAMETER | DEPTH | | | | BASIN | SOIL AMENDMENT | ORGANIC FERTILIZER | PACKET FERTILIZER | ON CENTER SPACING | ETW | EP | FENCE | WALL | PAVED DITCH | | EARTH DITCH |
| | | | | | | | | | | | | | | | | | | | | | |
| B (No. 5) | 1 | | NERIUM OLEANDER 'SISTER AGNES' | SISTER AGNES OLEANDER | 24" | 24" | II | | 1 | 2 | 1 | 1 | 15 | 15 | 15 | 15 | 15 | 15 | 17 | SHRUB | |
| | 2 | | NERIUM OLEANDER 'LITTLE RED' | LITTLE RED OLEANDER | 24" | 24" | II | | 1 | 2 | 1 | 1 | 6 | 10 | 10 | 10 | 10 | 10 | 12 | SHRUB | |
| | 3 | | MONARD JUNIPERUS SABINA | MOOR-DENSE JUNIPER | 24" | 24" | II | | 1 | 2 | 1 | 1 | 5 | 6 | 6 | 8 | 8 | 8 | 8 | 8 | SHRUB |
| | 4 | | TAGETES LEMMONII | MEXICAN MARIGOLD | 24" | 24" | II | | 1 | 2 | 1 | 1 | 4 | 4 | 4 | 4 | 4 | 4 | 4 | 4 | SHRUB |
| T (SOD) | 5 | | AGROSTIS PALLENS | NATIVE BENT GRASS TURF | | | | 2670 | | 6 CY/ 1000 SQFT | 6 LB/ 1000 SQFT | | | | | | | | | SOD ③ | |
| U (No. 15) | 6 | | CUPRESSUS SEMPERVIRENS 'FASTIGIATA' | ITALIAN CYPRESS | 36" | 36" | II | | 2 | 3 | 2 | 2 | 6 | 6 | 6 | 6 | 6 | 6 | 6 | TREE ② ④ ⑤ | |
| | 7 | | PISTACHIA CHINENSIS 'KEITH DAVEY' | KEITH DAVEY CHINESE PISTACHE | 36" | 36" | II | | 2 | 3 | 2 | 2 | 25 | 40 | 40 | 20 | 20 | 20 | 22 | TREE ② ④ ⑤ | |
| | 8 | | SEQUOIA SEMPERVIRENS 'APTOS BLUE' | APTOS BLUE REDWOOD | 36" | 36" | II | | 2 | 3 | 2 | 2 | 20 | 30 | 30 | 20 | 20 | 20 | 22 | TREE ② ④ ⑤ | |
| | 9 | | QUERCUS AGRIFOLIA | COAST LIVE OAK | 36" | 36" | II | | 0 | 0 | 0 | 0 | 20 | 25 | 25 | 20 | 15 | 15 | 17 | TREE ② ④ ⑤ ⑥ | |

NOTES: APPLICABLE WHERE CIRCLED

- ① QUANTITIES SHOWN ARE "PER PLANT" UNLESS SHOWN AS SOFT OR SQYD APPLICATION RATES
- ② TREE STAKING REQUIRED
- ③ AREA TO BE CULTIVATED PRIOR TO PLANTING
- ④ FOLIAGE PROTECTOR REQUIRED
- ⑤ ROOT PROTECTOR REQUIRED
- ⑥ SEE SHEET PP-2 FOR NOTES ON BARK MULCH, PLANTING WITHIN SMP-32 AREA AND TREES TO BE TRANSPLANTED.

LEGEND:



SOD AREA. NATIVE BENT GRASS (AGROSTIS PALLENS) CULTIVATE AREA PRIOR TO INSTALLING SOD

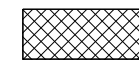

DRY SEED AGROSTIS PALLENS. SEED BY HAND AT 50 LBS PER ACRE. CULTIVATE AREA PRIOR TO SEEDING.

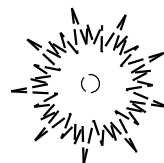

EXISTING REDWOOD TREE TO REMAIN. PROTECT IN PLACE DURING CONSTRUCTION. DELINEATE REDWOODS SHOWN ON PLANTING PLANS WITH HIGH VISIBILITY TEMPORARY FENCING. DO NOT ENTER DELINEATED AREA. DO NOT ALLOW DISCHARGE OR SPILLAGE OF ANY PRODUCT THAT WILL EFFECT THE VIGOR OF THE EXISTING REDWOODS.

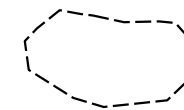

ROADSIDE CLEARING WORK LIMITS AND PLANT ESTABLISHMENT WORK LIMITS



WOOD CHIP MULCH



EDGING

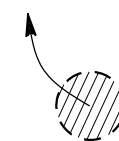

TREE TO BE TRANSPLANTED.

PLANT LEGEND

PL-1

| Dist | COUNTY | ROUTE | POST MILES TOTAL PROJECT | SHEET No. | TOTAL SHEETS |
|------|--------|--------|---------------------------|-----------|--------------|
| 04 | Ala | 84,680 | 17.9/R22.9 R10.3/R15.3 | 05 | |

Leah Haygood
LICENSED LANDSCAPE ARCHITECT

PLANS APPROVAL DATE

THE STATE OF CALIFORNIA OR ITS OFFICERS OR AGENTS SHALL NOT BE RESPONSIBLE FOR THE ACCURACY OR COMPLETENESS OF SCANNED COPIES OF THIS PLAN SHEET.

HAYGOOD AND ASSOCIATES ALAMEDA CTC
1436-B Solano Avenue 1111 Broadway
Albany, CA 94706 Suite 800
Oakland, CA 94607

LICENSED LANDSCAPE ARCHITECT
LEAH HAYGOOD
signature
8-31-21
Date
RENEWAL DATE

NOTE:
FOR ACCURATE RIGHT OF WAY DATA, CONTACT RIGHT OF WAY ENGINEERING AT THE DISTRICT OFFICE.

PLANTING NOTES
APPLY 6 CY OF SOIL AMENDMENT AND 6 LB OF ORGANIC FERTILIZER PER 1000 SQFT TO DRY SEED AREA PRIOR TO CULTIVATION.

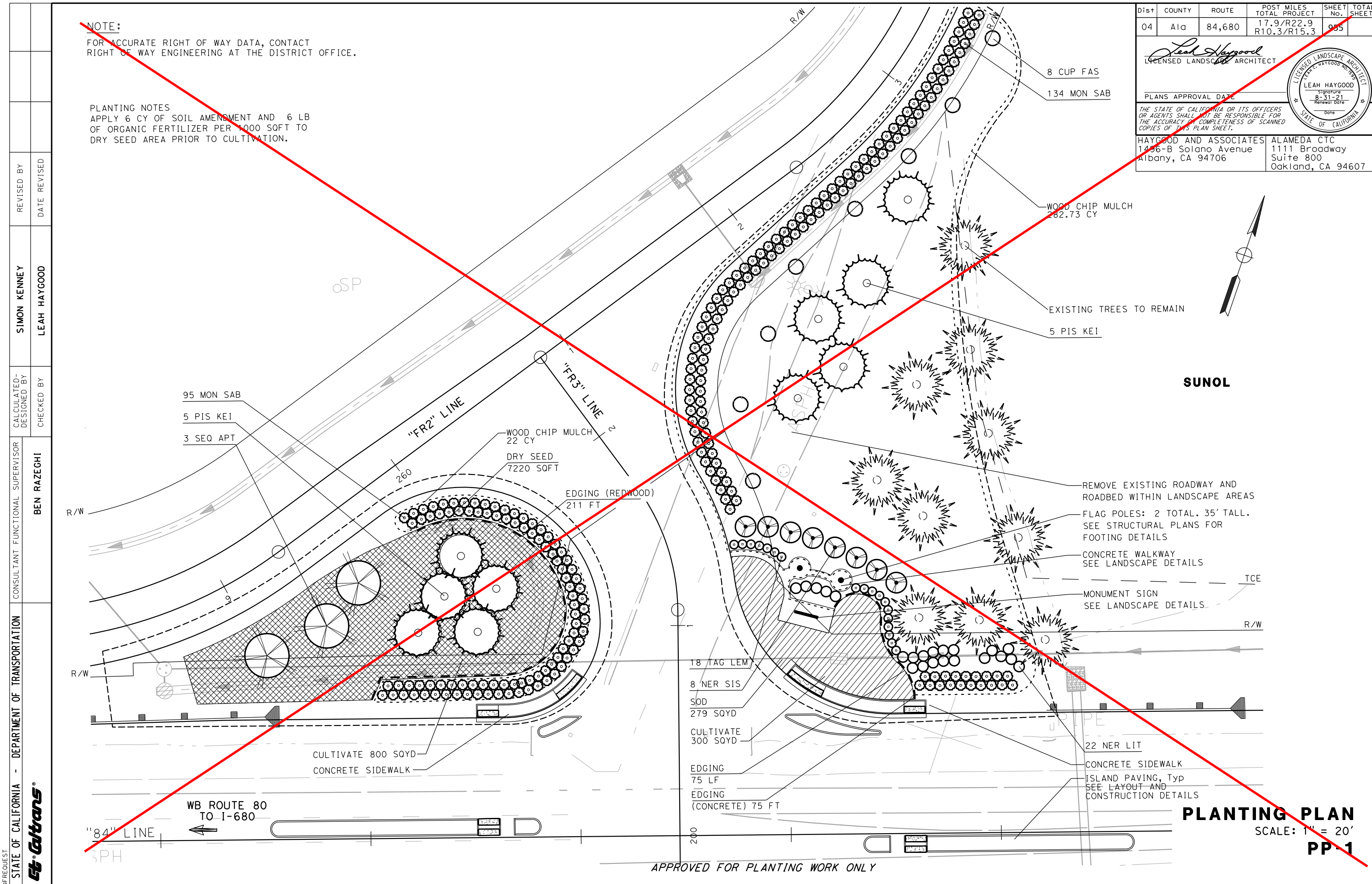

| REVISION | DATE | BY | DESCRIPTION |
|----------|------|----|-------------|
| | | | |

| | | | | |
|--|----------------------------------|------------------------|---------|------|
| STATE OF CALIFORNIA - DEPARTMENT OF TRANSPORTATION | CONSULTANT FUNCTIONAL SUPERVISOR | CALCULATED/DESIGNED BY | REVISOR | DATE |
| BEN RAZECHI | BEN RAZECHI | SIMON KENNEY | | |
| LEAH HAYGOOD | | | | |

| Dist | COUNTY | ROUTE | POST MILES TOTAL PROJECT | SHEET No. | TOTAL SHEETS |
|------|--------|--------|---------------------------|-----------|--------------|
| 04 | Ala | 84,680 | 17.9/R22.9 R10.3/R15.3 | 956 | |

Leah Haygood
LICENSED LANDSCAPE ARCHITECT

PLANS APPROVAL DATE _____

THE STATE OF CALIFORNIA OR ITS OFFICERS OR AGENTS SHALL NOT BE RESPONSIBLE FOR THE ACCURACY OR COMPLETENESS OF SCANNED COPIES OF THIS PLAN SHEET.

HAYGOOD AND ASSOCIATES | ALAMEDA CTC
1496-B Solano Avenue | 1111 Broadway
Albany, CA 94706 | Suite 800
Oakland, CA 94607

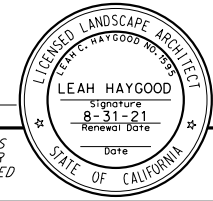

NOTES

- 1 RIGHT OF WAY ENGINEERING AT THE DISTRICT OFFICE.
- 2 BARK MULCH;
 - 2.1 TREES TO BE REMOVED, EXCEPT PERUVIAN PEPPER, THAT ARE HEALTHY ARE TO BE CHIPPED ON SITE. STOCKPILE CHIPPED MATERIAL ADJACENT TO NEW PLANTING AREA FOR REUSE. REMOVED PERUVIAN PEPPERS ARE TO BE REMOVED FROM SITE.
 - 2.2 TREES TO BE REMOVED THAT ARE NOT HEALTHY, SHOULD NOT BE CHIPPED. REMOVE UNHEALTHY TREES FROM SITE.
 - 2.3 DO NOT BREAK DOWN UNHEALTHY TREES BY CHIPPING THEM IN THE SAME CHIPPER USED FOR HEALTHY TREES THAT ARE TO BE CHIPPED.
- 3 PLANTING WORK WITHIN SMP-32 AREA OF WORK ONLY;
 - 3.1 NOT ALLOWED ON SITE: IMPORTED SOIL, SOIL AMENDMENTS, COMPOST, FERTILIZERS, WEED AND PEST CONTROL CHEMICALS, IMPORTED PLANTS, PRESSURE TREATED TREE STAKES.
 - 3.2 OMIT FROM STANDARD PROJECT SPECIFICATIONS AND SPECIAL PROVISIONS FOR LANDSCAPE THE ITEMS INCLUDED IN NOTE #3.1.
 - 3.3 NEW COAST LIVE OAK TREE SEEDLINGS FOR PROJECT WILL BE GROWN AND PROVIDED BY SFPUC.
 - 3.4 EXISTING MATURE TREES TO BE RELOCATED AND TRANSPLANTED ARE SHOWN ON PLANS.
 - 3.5 EXCAVATE PLANTING HOLES. PLACE PLANT IN HOLE AND BACKFILL WITH EXCAVATED EARTH.
 - 3.6 WATER PLANTS USING ON SITE WATER SOURCES.
 - 3.7 BARK MULCH: INSTALL STOCKPILED CHIPPED BARK AS MULCH AROUND NEW AND RELOCATED TREES.
 - 3.8 INSTALL FOLIAGE PROTECTORS FOR SFPUC-SUPPLIED TREES.
 - 3.9 INSTALL ROOT PROTECTOR AT EACH TREE THAT IS GROWN AND PROVIDED BY SFPUC. DO NOT INSTALL ON TREES THAT ARE RELOCATED

- 4 TREES TO BE RELOCATED AND TRANSPLANTED
 - 4.1 ALL TREES TO BE RELOCATED AND TRANSPLANTED ARE QUERCUS AGRIFOLIA
 - 4.2 ARBORIST TO MARK TREES TO BE RELOCATED AND TRANSPLANTED
 - 4.3 FOR TREE IDENTIFICATION NUMBERS REFER TO TREE REMOVAL PLANS

LEGEND

- QUERCUS AGRIFOLIA
- COAST LIVE OAK
- 15 GAL SUPPLIED BY SFPUC

SMP 32

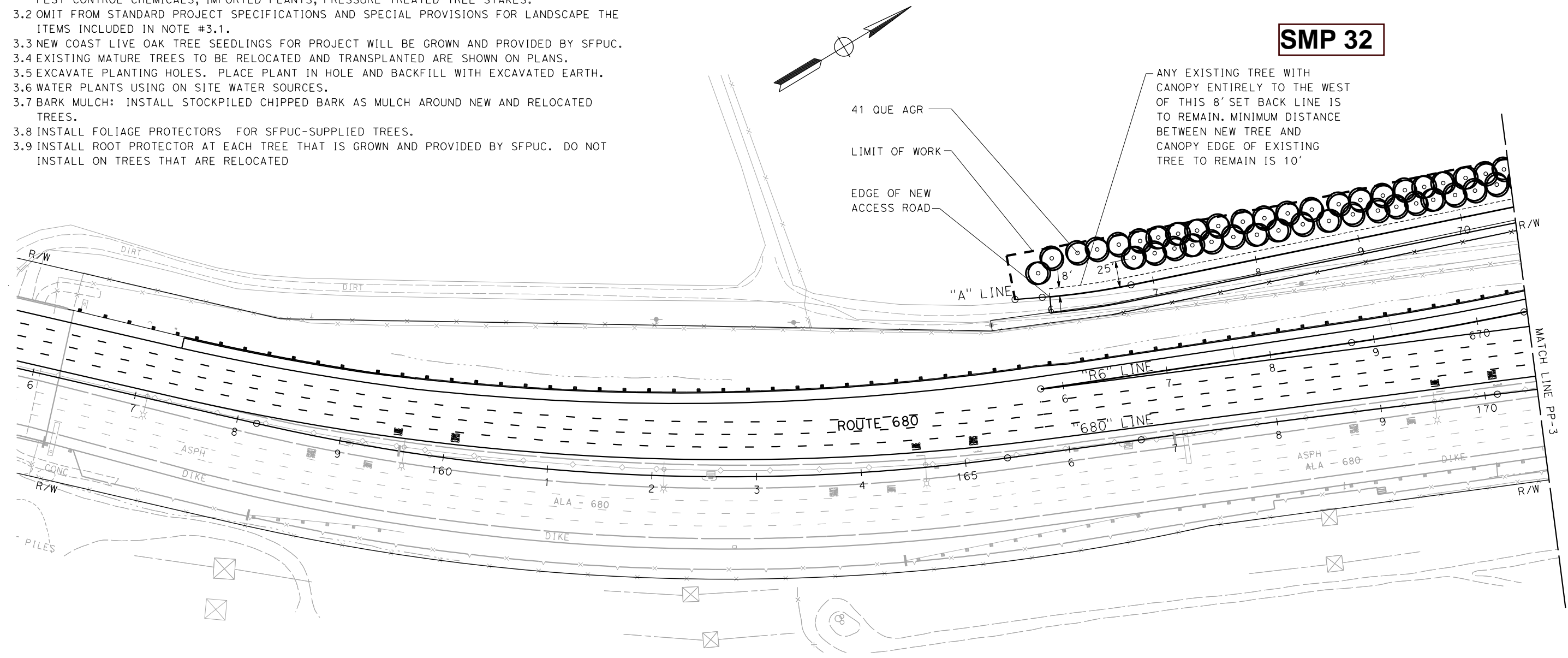

#REQUEST STATE OF CALIFORNIA - DEPARTMENT OF TRANSPORTATION
 CONSULTANT FUNCTIONAL SUPERVISOR BEN RAZECHI
 CALCULATED/DESIGNED BY SIMON KENNEY
 CHECKED BY LEAH HAYGOOD
 REVISED BY DATE
 SIMON KENNEY
 LEAH HAYGOOD
 DATE REVISED



APPROVED FOR PLANTING WORK ONLY

PLANTING PLAN
SCALE: 1" = 50'
PP-2

LAST REVISION DATE PLOTTED => 4/17/2020
 07-20-16 TIME PLOTTED => 10:38:38 AM

| Dist | COUNTY | ROUTE | POST MILES TOTAL PROJECT | SHEET No. | TOTAL SHEETS |
|------|--------|--------|---------------------------|-----------|--------------|
| 04 | Ala | 84,680 | 17.9/R22.9 R10.3/R15.3 | 957 | |

Leah Haygood
LICENSED LANDSCAPE ARCHITECT

PLANS APPROVAL DATE _____

THE STATE OF CALIFORNIA OR ITS OFFICERS OR AGENTS SHALL NOT BE RESPONSIBLE FOR THE ACCURACY OR COMPLETENESS OF SCANNED COPIES OF THIS PLAN SHEET.

HAYGOOD AND ASSOCIATES ALAMEDA CTC
1496-B Solano Avenue Suite 800
Albany, CA 94706

ALAMEDA CTC
1111 Broadway
Oakland, CA 94607



NOTES

1. RIGHT OF WAY ENGINEERING AT THE DISTRICT OFFICE.
2. SEE SHEET PP-2 FOR NOTES ON BARK MULCH, PLANTING WITHIN SMP-32 AREA AND TREES TO BE RELOCATED AND TRANSPLANTED.

LEGEND

- QUERCUS AGRIFOLIA
- COAST LIVE OAK
- 15 GAL SUPPLIED BY SFPUC

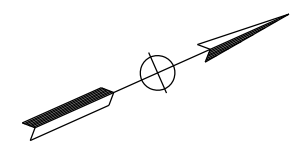

SMP 32

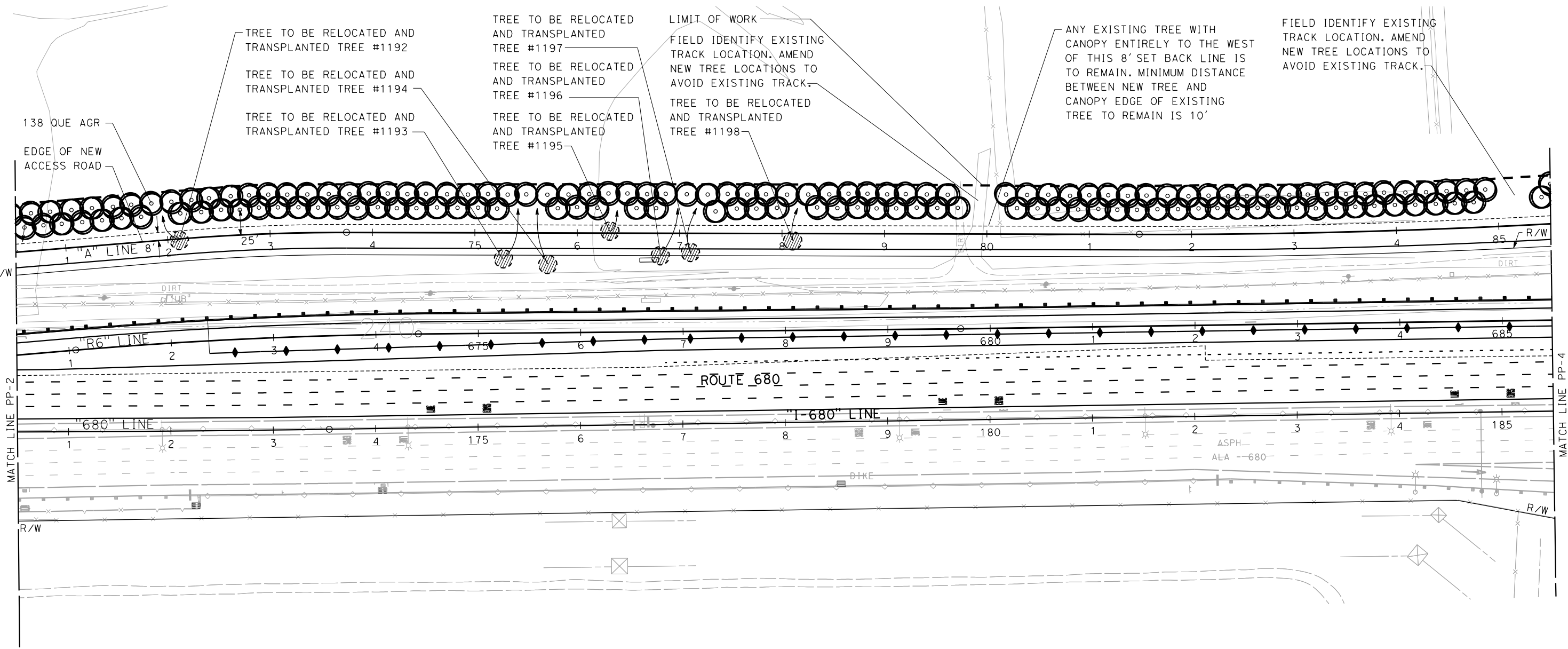

#REQUEST STATE OF CALIFORNIA - DEPARTMENT OF TRANSPORTATION
 CALCULATED/DESIGNED BY: SIMON KENNEY
 CHECKED BY: LEAH HAYGOOD
 CONSULTANT FUNCTIONAL SUPERVISOR: BEN RAZEGHI
 REVISIONS: 1, 2, 3, 4, 5, 6, 7, 8, 9, 10, 11, 12, 13, 14, 15, 16, 17, 18, 19, 20, 21, 22, 23, 24, 25, 26, 27, 28, 29, 30, 31, 32, 33, 34, 35, 36, 37, 38, 39, 40, 41, 42, 43, 44, 45, 46, 47, 48, 49, 50, 51, 52, 53, 54, 55, 56, 57, 58, 59, 60, 61, 62, 63, 64, 65, 66, 67, 68, 69, 70, 71, 72, 73, 74, 75, 76, 77, 78, 79, 80, 81, 82, 83, 84, 85, 86, 87, 88, 89, 90, 91, 92, 93, 94, 95, 96, 97, 98, 99, 100



APPROVED FOR PLANTING WORK ONLY

PLANTING PLAN
SCALE: 1" = 50'
PP-3

| | | | | | |
|------|--------|--------|---------------------------|-----------|--------------|
| Dist | COUNTY | ROUTE | POST MILES TOTAL PROJECT | SHEET No. | TOTAL SHEETS |
| 04 | Ala | 84,680 | 17.9/R22.9 R10.3/R15.3 | 958 | |

Leah Haygood
LICENSED LANDSCAPE ARCHITECT

PLANS APPROVAL DATE _____

THE STATE OF CALIFORNIA OR ITS OFFICERS OR AGENTS SHALL NOT BE RESPONSIBLE FOR THE ACCURACY OR COMPLETENESS OF SCANNED COPIES OF THIS PLAN SHEET.

HAYGOOD AND ASSOCIATES ALAMEDA CTC
1496-B Solano Avenue 1111 Broadway
Albany, CA 94706 Suite 800
Oakland, CA 94607

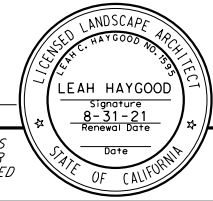

NOTES

- RIGHT OF WAY ENGINEERING AT THE DISTRICT OFFICE.
- SEE SHEET PP-2 FOR NOTES ON BARK MULCH, PLANTING WITHIN SMP-32 AREA AND TREES TO BE RELOCATED AND TRANSPLANTED.

LEGEND

○ QUERCUS AGRIFOLIA ○ COAST LIVE OAK ○ 15 GAL SUPPLIED BY SFPUC

SMP 32

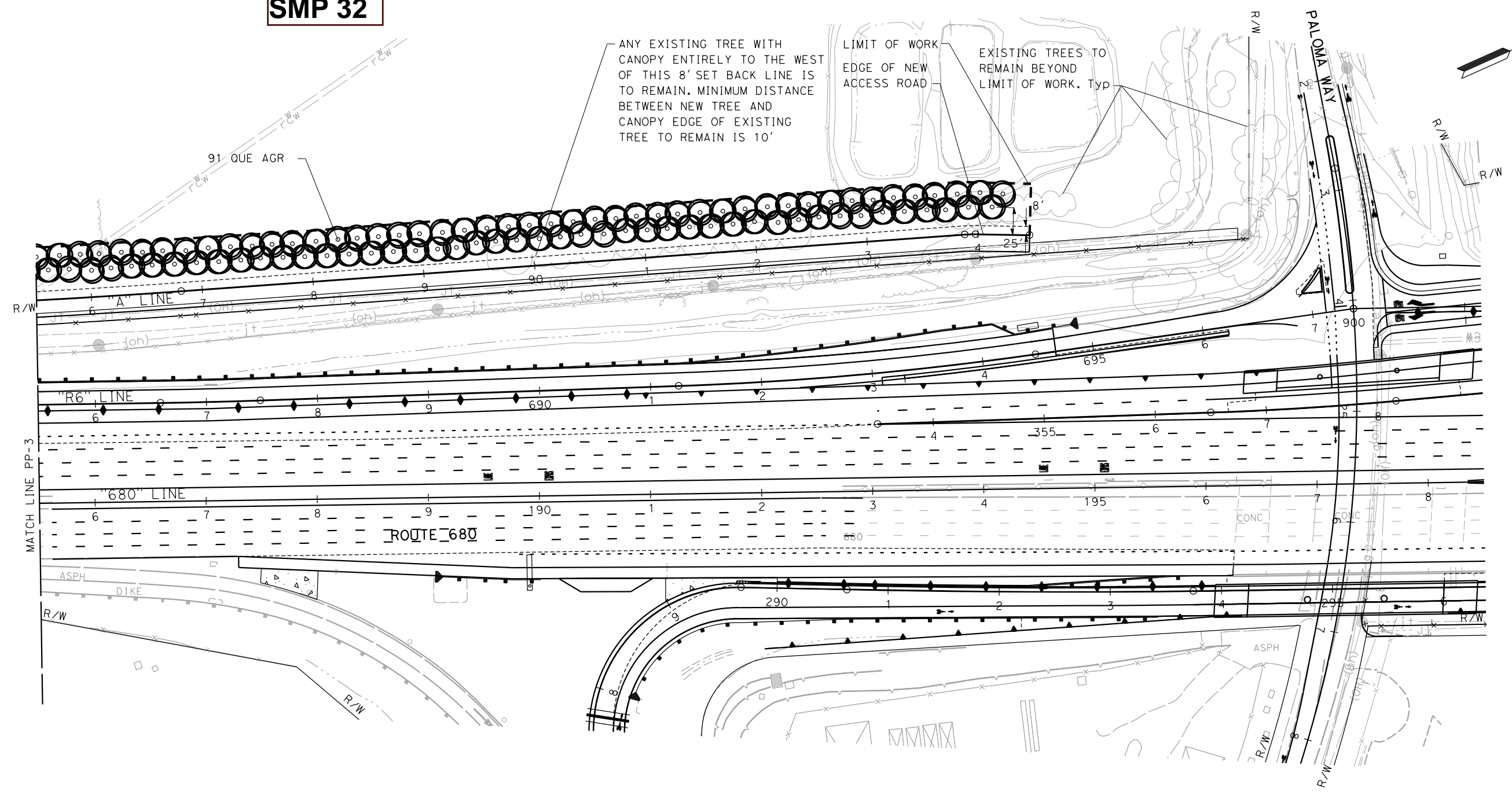

STATE OF CALIFORNIA - DEPARTMENT OF TRANSPORTATION

Ben Razeghi

Simon Kenney

Leah Haygood

Caltrans

PLANTING PLAN
SCALE: 1" = 50'
PP-4

APPROVED FOR PLANTING WORK ONLY

LAST REVISION | DATE PLOTTED => 4/17/2020
07-20-16 | TIME PLOTTED => 10:36:41 AM

| | | | | | |
|------|--------|--------|-----------------------------|--------------|-----------------|
| Dist | COUNTY | ROUTE | POST MILES TOTAL PROJECT | SHEET No. | TOTAL SHEETS |
| 04 | Ala | 84,680 | 17.9/R22.9 R10.3/R15.3 | 959 | |

 LICENSED LANDSCAPE ARCHITECT

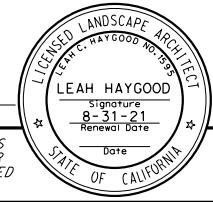

PLANS APPROVAL DATE _____
 Signature: LEAH HAYGOOD
 Date: 8-31-21
 Renewal Date: _____

THE STATE OF CALIFORNIA OR ITS OFFICERS OR AGENTS SHALL NOT BE RESPONSIBLE FOR THE ACCURACY OR COMPLETENESS OF SCANNED COPIES OF THIS PLAN SHEET.

HAYGOOD AND ASSOCIATES ALAMEDA CTC
 1496-B Solano Avenue 1111 Broadway
 Albany, CA 94706 Suite 800
 Oakland, CA 94607

PLANT QUANTITIES

| BOTANICAL NAME | COMMON NAME | PLANT GROUP | | | PLANT BASIN | | | | | |
|-------------------------------------|------------------------------|-------------|-------|---------|-----------------------|---------------------|--------------------|------------------------|--------------------|-----------------------|
| | | B (N) | U (N) | SOD (N) | PACKET FERTILIZER (N) | WOOD CHIP MULCH (N) | SOIL AMENDMENT (N) | ORGANIC FERTILIZER (N) | ROOT PROTECTOR (N) | FOLIAGE PROTECTOR (N) |
| | | EA | EA | SQYD | EA | CY | CY | LB | EA | EA |
| NERIUM OLEANDER 'SISTER AGNES' | SISTER AGNES OLEANDER | 8 | | | 8 | 0.30 | 0.59 | 0.50 | | |
| NERIUM OLEANDER 'LITTLE RED' | LITTLE RED OLEANDER | 22 | | | 22 | 0.81 | 1.63 | 1.38 | | |
| MONARD JUNIPERUS SABINA | MOOR-DENSE JUNIPER | 229 | | | 229 | 8.48 | 16.96 | 14.31 | | |
| TAGETES LEMMONII | MEXICAN MARIGOLD | 18 | | | 18 | 0.67 | 1.33 | 1.13 | | |
| TURF | | | | 279 | | | | | | |
| CUPRESSUS SEMPERVIRENS 'FASTIGIATA' | ITALIAN CYPRESS | | 8 | | 16 | 0.59 | 0.89 | 1.00 | 8 | 8 |
| PISTACHIA CHINENSIS 'KEITH DAVEY' | KEITH DAVEY CHINESE PISTACHE | | 10 | | 20 | 0.74 | 1.11 | 1.25 | 10 | 10 |
| QUERCUS AGRIFOLIA | COAST LIVE OAK | | 270** | | 0 | 0 | 0 | 0 | 0 | 0 |
| SEQUOIA SEMPERVIRENS 'APTOS BLUE' | APTOS BLUE REDWOOD | | 3 | | 6 | 0.22 | 0.33 | 0.38 | 3 | 3 |
| | SUBTOTAL | | | | | 11.81 | 22.85 | 19.94 | | |
| | TOTAL | 277 | 291 | 279 | 319 | | | | 21 | 21 |

(N) - NOT A SEPARATE PAY ITEM, FOR INFORMATION ONLY
 (***) - PLANTS TO BE SUPPLIED BY SFPUC NURSERY

PLANTING AREA QUANTITIES

| SHEET No. | CULTIVATION (N) | CULTIVATION AREA | | WOOD CHIP MULCH (N) | EDGING (REDWOOD) (N) | EDGING (CONCRETE) (N) | DRY SEED (N) | CLASS 2 AGGREGATE BASE | MINOR CONCRETE (MISCELLANEOUS CONSTRUCTION) |
|----------------------|-----------------|--------------------|------------------------|---------------------|----------------------|-----------------------|--------------|------------------------|---|
| | | SOIL AMENDMENT (N) | ORGANIC FERTILIZER (N) | | | | | | |
| | | SQYD | CY | | | | | | |
| PP-1 | 1100 | 6.6 | 6.60 | 304.11 | 211 | 75 | 7220 | 12 | 8 |
| | | | | | | | | | |
| PLANT BASIN SUBTOTAL | | 22.85 | 19.94 | 11.81 | | | | | |
| TOTAL | 1100 | 29.45 | 26.54 | 315.92 | 211 | 75 | 7220 | 12* | 8* |

(N) - NOT A SEPARATE PAY ITEM, FOR INFORMATION ONLY
 (*) - QUANTITY INCLUDED IN ROADWAY SUMMARY TABLE.

PLANTING QUANTITIES
PQ-1

#REQUEST STATE OF CALIFORNIA - DEPARTMENT OF TRANSPORTATION CONSULTANT FUNCTIONAL SUPERVISOR BEN RAZEGLI CALCULATED/DESIGNED BY SIMON KENNEY LEAH HAYGOOD CHECKED BY LEAH HAYGOOD REVISOR DATE REVISED BY DATE REVISED

LAST REVISION | DATE PLOTTED => 4/17/2020 07-20-16 | TIME PLOTTED => 10:38:41 AM

I-680/SR 84 INTERCHANGE IMPROVEMENTS AND SR 84 WIDENING PROJECT

SMP 32 PLANT REPLACEMENT PLANS

IRRIGATION SPRINKLER SCHEDULE

| SYMBOL | ITEM DESCRIPTION | SPRAY PATTERN | RADIUS ft | OPERATING PRESSURE psi | DISCHARGE RATE (+/- 5%) | | PRECIPITATION RATE (+/- 5%) INCH/hr | INLET CONNECTION DIAMETER INCH | SWING JOINT TYPE | RISER SPRINKLER ASSEMBLY | | | POP-UP SPRINKLER ASSEMBLY | REMARKS |
|--------|------------------------------|---------------|--------------|---------------------------|----------------------------|-----|---|--------------------------------------|------------------|--------------------------|-----------------------|----------|---------------------------|------------------------------|
| | | | | | GPM | GPH | | | | TYPE | HEIGHT/LENGTH INCH | MATERIAL | HEIGHT INCH | |
| | | | | | | | | | | | | | | |
| ● | RISER SPRINKLER ASSEMBLY | | | 30 | 0.25 | | | 1/2 | | v | 7 | PL | | 8 |
| ■ | RISER SPRINKLER ASSEMBLY | | | 30 | 0.5 | | | 1/2 | | v | 7 | PL | | 8 9 |
| ⊞ | RISER SPRINKLER ASSEMBLY | | | 30 | 0.5 | | | 1/2 | | v | 7 | PL | | 8 10 |
| ▼ | POP-UP SPRINKLER ASSEMBLY | Q | 8-10 | 30 | 0.23 | | 1.2 | 3/4 | II | | | PL | 12 | |
| ▼ | POP-UP SPRINKLER ASSEMBLY | H | 8-10 | 30 | 0.51 | | 1.1 | 3/4 | II | | | PL | 12 | |
| 5 | GEAR DRIVEN POP-UP | Q | 25-30 | 45 | 1.6 | | 0.30 | 3/4 | II | | | PL | 12 | |
| 5 | GEAR DRIVEN POP-UP | H | 25-30 | 45 | 3.0 | | 0.51 | 3/4 | II | | | PL | 12 | |
| 5 | GEAR DRIVEN POP-UP | F | 25-30 | 45 | 3.0 | | 0.51 | 3/4 | II | | | PL | 12 | |
| ● | POP-UP SPRINKLER ASSEMBLY | F | 10-12 | 30 | 1.5 | | 1.1 | 3/4 | II | | | PL | 6 | |
| ⊕ | POP-UP SPRINKLER ASSEMBLY | Q | 12-15 | 30 | 0.6 | | 1.1 | 3/4 | II | | | PL | 6 | |
| ⊖ | POP-UP SPRINKLER ASSEMBLY | H | 12-15 | 30 | 1.2 | | 1.1 | 3/4 | II | | | PL | 6 | |
| ○ | POP-UP SPRINKLER ASSEMBLY | F | 12-15 | 30 | 2.3 | | 1.1 | 3/4 | II | | | PL | 6 | |
| ⊙ | PLASTIC PIPE IRRIGATION LINE | | | 30 | | 0.5 | | | | PPIL | | PL | | INSTALL AROUND EXIST TREES 7 |

NOTES: APPLICABLE WHERE CIRCLED

- 1 - SEE SPECIAL PROVISIONS.
- 2 - IF A PRESSURE COMPENSATING DEVICE IS SPECIFIED, THE DISCHARGE AND RADII SHOWN REFLECT ITS USE.
- 3 - ARC STOP SHALL BE FITTED WITH A NUT AND BOLT.
- 4 - VINYL-COATED CAST IRON HOUSING.
- 5 - SWING JOINTS REQUIRED ADJACENT TO SHOULDERS, CURBS, SIDEWALKS, AND DIKES.
- 6 - UNLESS OTHERWISE SHOWN ON PLANS.
- 7 - SEE DETAIL
- 8 - SEE IRRIGATION NOTE 1
- 9 - SEE IRRIGATION NOTE 4
- 10 - SEE IRRIGATION NOTE 5

IRRIGATION SYMBOLS:

⊕ (FV) FLUSHING VALVE

NOTES:

1. INSTALL RISER SPRINKLER ASSEMBLY (TYPE V) ON UPHILL SIDE OF PLANT BASIN.
2. PLASTIC PIPE SUPPLY LINE FOR SPRINKLER ASSEMBLY (TYPE V) MUST BE SIZED IN ACCORDANCE WITH PIPE SIZING CHART, UNLESS OTHERWISE NOTED.
3. INSTALL IRRIGATION SYSTEM DOWNSTREAM FROM CONTROL (BV) VALVE ON GRADE.
4. INSTALL TWO BUBBLERS FOR EACH TREE (NO. 15 AND 24" BOX SIZES). ONE BUBBLER IS SHOWN FOR GRAPHIC CLARITY.
5. INSTALL FOUR BUBBLERS FOR EACH TRANSPLANTED TREE. ONE BUBBLER IS SHOWN FOR GRAPHIC CLARITY.

PIPE SIZING CHART RISER SPRINKLER ASSEMBLY (TYPE V)

| SPRINKLER (0.25 GPM) | |
|----------------------|-----------|
| No. BUBBLERS | PIPE SIZE |
| 1-24 | 3/4" |
| 25-48 | 1" |
| 49-120 | 1 1/2" |
| SPRINKLER (0.5 GPM) | |
| No. BUBBLERS | PIPE SIZE |
| 1-6 | 3/4" |
| 7-12 | 1" |
| 13-32 | 1 1/2" |

IRRIGATION SPRINKLER SCHEDULE ISS-1

| | | | | | |
|------|--------|--------|-----------------------------|--------------|-----------------|
| Dist | COUNTY | ROUTE | POST MILES TOTAL PROJECT | SHEET No. | TOTAL SHEETS |
| 04 | Ala | 84,680 | 17.9/R22.9 R10.3/R15.3 | 945 | |

 LICENSED LANDSCAPE ARCHITECT

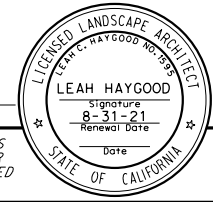
 LEAH HAYGOOD
 Signature
 8-31-21
 Renewal Date

PLANS APPROVAL DATE _____

THE STATE OF CALIFORNIA OR ITS OFFICERS OR AGENTS SHALL NOT BE RESPONSIBLE FOR THE ACCURACY OR COMPLETENESS OF SCANNED COPIES OF THIS PLAN SHEET.

HAYGOOD AND ASSOCIATES | ALAMEDA CTC
 1496-B Solano Avenue | 1111 Broadway
 Albany, CA 94706 | Suite 800
 Oakland, CA 94607

STATE OF CALIFORNIA - DEPARTMENT OF TRANSPORTATION
 CONSULTANT FUNCTIONAL SUPERVISOR
 BEN RAZECHI
 CALCULATED/DESIGNED BY
 CHECKED BY
 LANCE BLANCHARD
 CHRIS MITCHELL
 REVISED BY
 DATE REVISED

| | | | | | |
|------|--------|--------|---------------------------|-----------|--------------|
| Dist | COUNTY | ROUTE | POST MILES TOTAL PROJECT | SHEET No. | TOTAL SHEETS |
| 04 | Ala | 84,680 | 17.9/R22.9 R10.3/R15.3 | 947 | |

LEAH HAYGOOD
 LICENSED LANDSCAPE ARCHITECT

PLANS APPROVAL DATE

THE STATE OF CALIFORNIA OR ITS OFFICERS OR AGENTS SHALL NOT BE RESPONSIBLE FOR THE ACCURACY OR COMPLETENESS OF SCANNED COPIES OF THIS SHEET.

HAYGOOD AND ASSOCIATES ALAMEDA CTC
 1496 B Solano Avenue Suite 800
 Albany, CA 94706

1111 Broadway
 Oakland, CA 94607

NOTE:
 FOR ACCURATE RIGHT OF WAY DATA, CONTACT RIGHT OF WAY ENGINEERING AT THE DISTRICT OFFICE.

CONNECT TO RELOCATED EXISTING BFP/HYDRANT AT UN-NAMED ROADWAY INTERSECTION NORTH OF THIS LOCATION.

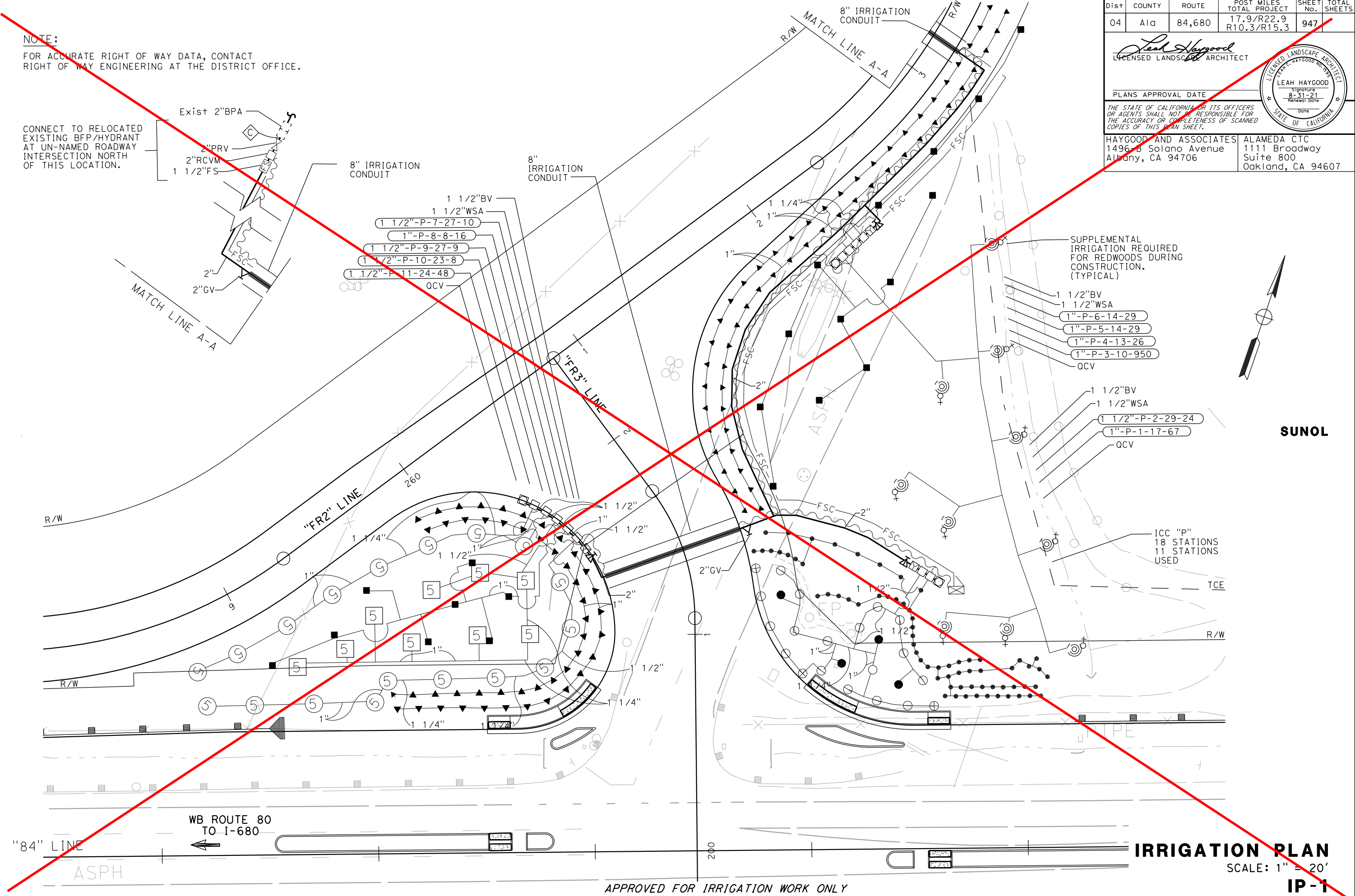

SUPPLEMENTAL IRRIGATION REQUIRED FOR REDWOODS DURING CONSTRUCTION. (TYPICAL)

- 1 1/2" BV
- 1 1/2" WSA
- 1"-P-6-14-29
- 1"-P-5-14-29
- 1"-P-4-13-26
- 1"-P-3-10-950
- OCV

- 1 1/2" BV
- 1 1/2" WSA
- 1 1/2"-P-2-29-24
- 1"-P-1-17-67
- OCV

ICC "P"
 18 STATIONS
 11 STATIONS USED

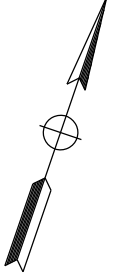

SUNOL

WB ROUTE 80 TO I-680

"84" LINE
 ASPH

IRRIGATION PLAN
 SCALE: 1" = 20'
IP-1

APPROVED FOR IRRIGATION WORK ONLY

LAST REVISION DATE PLOTTED => 4/17/2020 07-20-16 TIME PLOTTED => 10:38:30 AM

| Dist | COUNTY | ROUTE | POST MILES TOTAL PROJECT | SHEET No. | TOTAL SHEETS |
|------|--------|--------|---------------------------|-----------|--------------|
| 04 | Ala | 84,680 | 17.9/R22.9 R10.3/R15.3 | 948 | |

Leah Haygood
 LICENSED LANDSCAPE ARCHITECT
 PLANS APPROVAL DATE _____
THE STATE OF CALIFORNIA OR ITS OFFICERS OR AGENTS SHALL NOT BE RESPONSIBLE FOR THE ACCURACY OR COMPLETENESS OF SCANNED COPIES OF THIS PLAN SHEET.
 HAYGOOD AND ASSOCIATES | ALAMEDA CTC
 1496-B Solano Avenue | 1111 Broadway
 Albany, CA 94706 | Suite 800
 Oakland, CA 94607

NOTES
RIGHT OF WAY ENGINEERING AT THE DISTRICT OFFICE.

| | | | | | |
|----------|--|----------------------------------|------------------------|--------------|------|
| #REQUEST | STATE OF CALIFORNIA - DEPARTMENT OF TRANSPORTATION | CONSULTANT FUNCTIONAL SUPERVISOR | CALCULATED-DESIGNED BY | REVISOR | DATE |
| | | BEN RAZECHI | CHECKED BY | SIMON KENNEY | |
| | | | | LEAH HAYGOOD | |

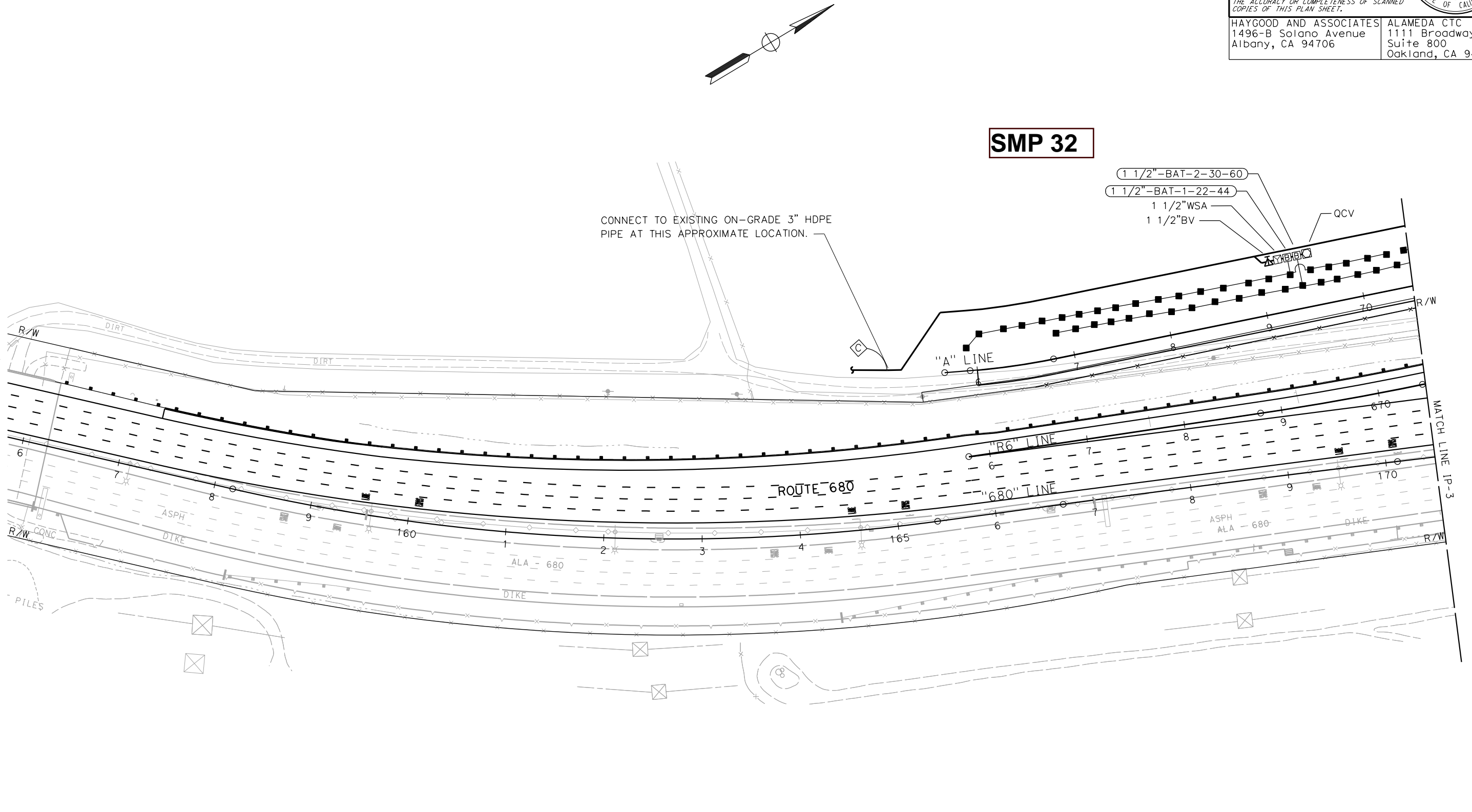

SMP 32

CONNECT TO EXISTING ON-GRADE 3" HDPE PIPE AT THIS APPROXIMATE LOCATION.

- 1 1/2" - BAT-2-30-60
- 1 1/2" - BAT-1-22-44
- 1 1/2" WSA
- 1 1/2" BV

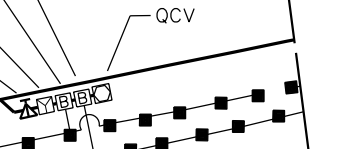

IRRIGATION PLAN
SCALE: 1" = 50'
IP-2

APPROVED FOR IRRIGATION WORK ONLY

LAST REVISION DATE PLOTTED => 4/17/2020
07-20-16 TIME PLOTTED => 10:38:31 AM

| | | | | | |
|------|--------|--------|---------------------------|-----------|--------------|
| Dist | COUNTY | ROUTE | POST MILES TOTAL PROJECT | SHEET No. | TOTAL SHEETS |
| 04 | Ala | 84,680 | 17.9/R22.9 R10.3/R15.3 | 949 | |

Leah Haygood
LICENSED LANDSCAPE ARCHITECT

PLANS APPROVAL DATE _____

THE STATE OF CALIFORNIA OR ITS OFFICERS OR AGENTS SHALL NOT BE RESPONSIBLE FOR THE ACCURACY OR COMPLETENESS OF SCANNED COPIES OF THIS PLAN SHEET.

HAYGOOD AND ASSOCIATES ALAMEDA CTC
1496-B Solano Avenue Suite 800
Albany, CA 94706

ALAMEDA CTC
1111 Broadway
Suite 800
Oakland, CA 94607

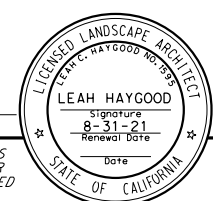

NOTES
RIGHT OF WAY ENGINEERING AT THE DISTRICT OFFICE.

SMP 32

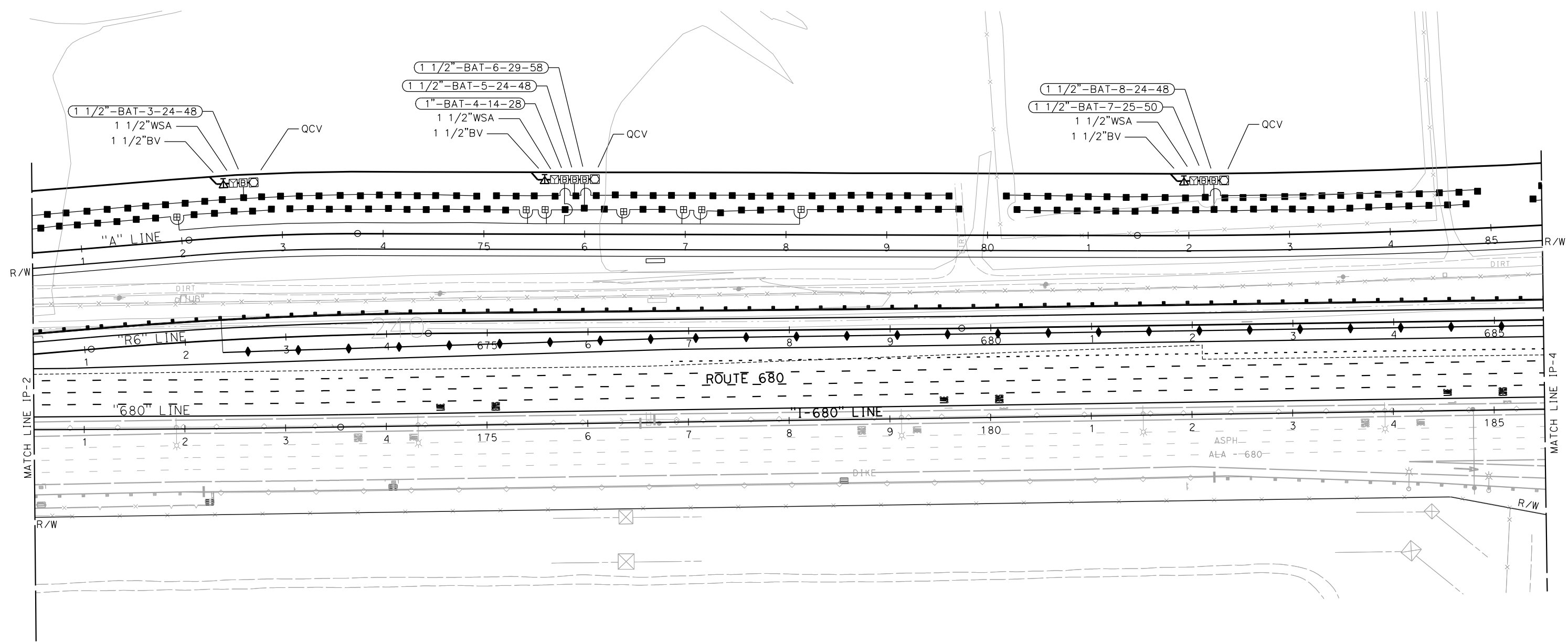
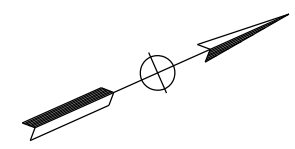

IRRIGATION PLAN
SCALE: 1" = 50'
IP-3

APPROVED FOR IRRIGATION WORK ONLY

| | | |
|--|------------------------|--------------|
| STATE OF CALIFORNIA - DEPARTMENT OF TRANSPORTATION | CONSULTANT SUPERVISOR | BEN RAZEHI |
| | CALCULATED-DESIGNED BY | CHECKED BY |
| | SIMON KENNEY | LEAH HAYGOOD |
| | REVISOR | DATE |

BORDER LAST REVISED 7/2/2010

USERNAME => Simon
DGN FILE => 0415000040sp003.dgn



UNIT 0736

PROJECT NUMBER & PHASE

04150000401

LAST REVISION | DATE PLOTTED => 4/17/2020
07-20-16 | TIME PLOTTED => 10:38:33 AM

NOTES
RIGHT OF WAY ENGINEERING AT THE DISTRICT OFFICE.

| | | | | | |
|------|--------|--------|---------------------------|-----------|--------------|
| Dist | COUNTY | ROUTE | POST MILES TOTAL PROJECT | SHEET No. | TOTAL SHEETS |
| 04 | Ala | 84,680 | 17.9/R22.9 R10.3/R15.3 | 950 | |

Leah Haygood
LICENSED LANDSCAPE ARCHITECT

PLANS APPROVAL DATE _____

THE STATE OF CALIFORNIA OR ITS OFFICERS OR AGENTS SHALL NOT BE RESPONSIBLE FOR THE ACCURACY OR COMPLETENESS OF SCANNED COPIES OF THIS PLAN SHEET.

HAYGOOD AND ASSOCIATES ALAMEDA CTC
1496-B Solano Avenue 1111 Broadway
Albany, CA 94706 Suite 800
Oakland, CA 94607

LICENSED LANDSCAPE ARCHITECT
LEAH HAYGOOD
signature
8-31-21
Renewal Date
Date
STATE OF CALIFORNIA

SMP 32

CONNECT TO EXISTING ON-GRADE 3" HDPE PIPE AT THIS APPROXIMATE LOCATION.

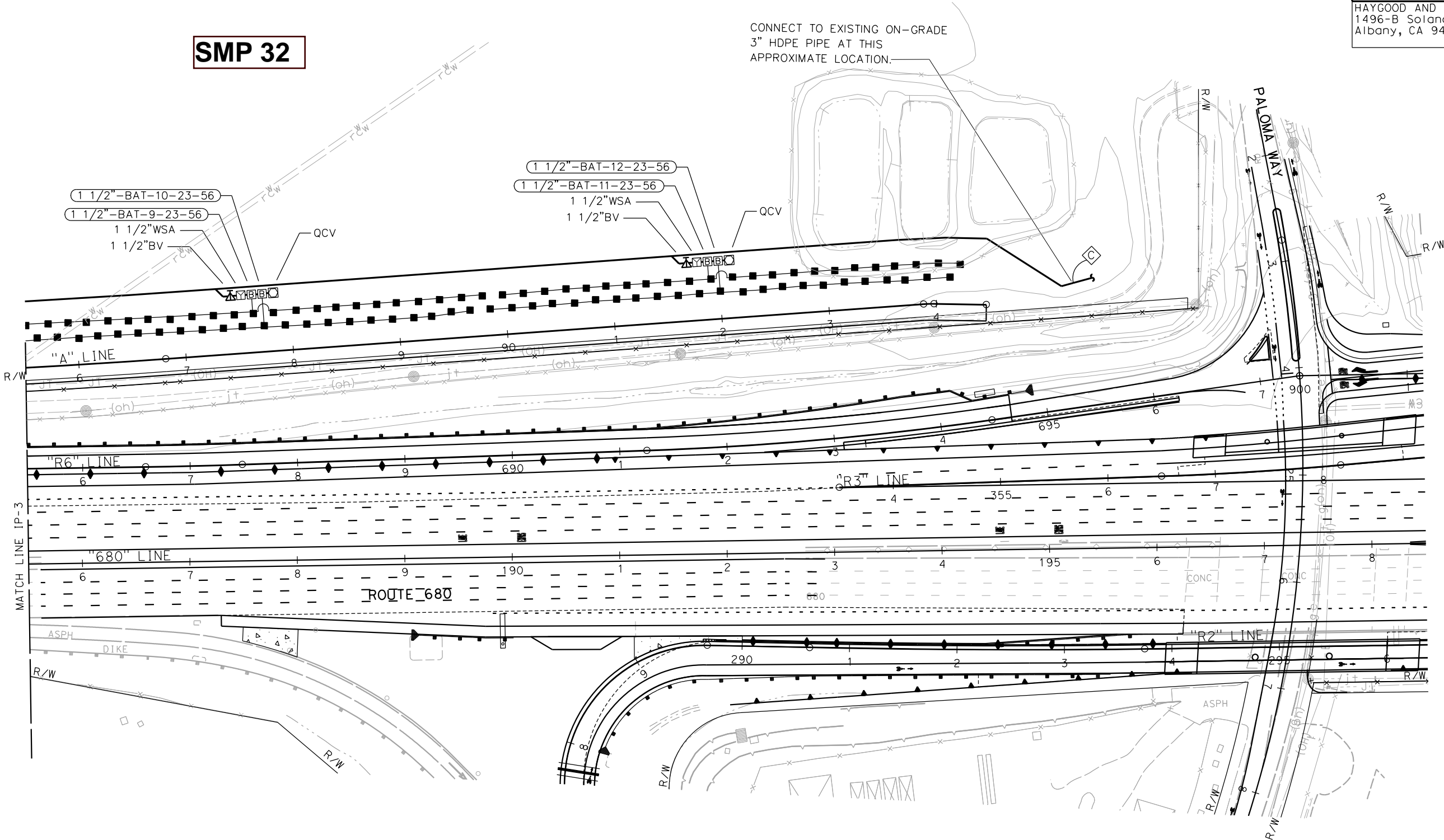

IRRIGATION PLAN
SCALE: 1" = 50'
IP-4

APPROVED FOR IRRIGATION WORK ONLY

STATE OF CALIFORNIA - DEPARTMENT OF TRANSPORTATION
#REQUEST
BORDER LAST REVISED 7/2/2010

CONSULTANT FUNCTIONAL SUPERVISOR
BEN RAZECHI

CALCULATED/DESIGNED BY
CHECKED BY

SIMON KENNEY
LEAH HAYGOOD

REVISOR BY
DATE REVISED

USERNAME => Simon
DGN FILE => 0415000040sp004.dgn

RELATIVE BORDER SCALE
IS IN INCHES

0 1 2 3

UNIT 0736

PROJECT NUMBER & PHASE
04150000401

LAST REVISION | DATE PLOTTED => 4/17/2020
07-20-16 | TIME PLOTTED => 10:38:34 AM

| | | | | | |
|------|--------|--------|-----------------------------|--------------|-----------------|
| Dist | COUNTY | ROUTE | POST MILES TOTAL PROJECT | SHEET No. | TOTAL SHEETS |
| 04 | Ala | 84,680 | 17.9/R22.9 R10.3/R15.3 | 951 | |

Leah Haygood
 LICENSED LANDSCAPE ARCHITECT

PLANS APPROVAL DATE _____
 LEAH HAYGOOD
 signature
 8-31-21
 Renewal Date
 Date _____
 STATE OF CALIFORNIA

THE STATE OF CALIFORNIA OR ITS OFFICERS OR AGENTS SHALL NOT BE RESPONSIBLE FOR THE ACCURACY OR COMPLETENESS OF SCANNED COPIES OF THIS PLAN SHEET.

| | |
|--|--|
| HAYGOOD AND ASSOCIATES 1496-B Solano Avenue Albany, CA 94706 | ALAMEDA CTC 1111 Broadway Suite 800 Oakland, CA 94607 |
|--|--|

- NOTES:**
1. INSTALL DIT ON GRADE AND STAKE DOWN EVERY 4' OR AS REQUIRED.
 2. SCHEDULE 40 PVC LATERAL LINE-STUB INTO EACH PLANTING AREA.
 3. CONVERT SCH 40 PVC LATERAL LINE TO DIT WITH A FEMALE T ADAPTER.

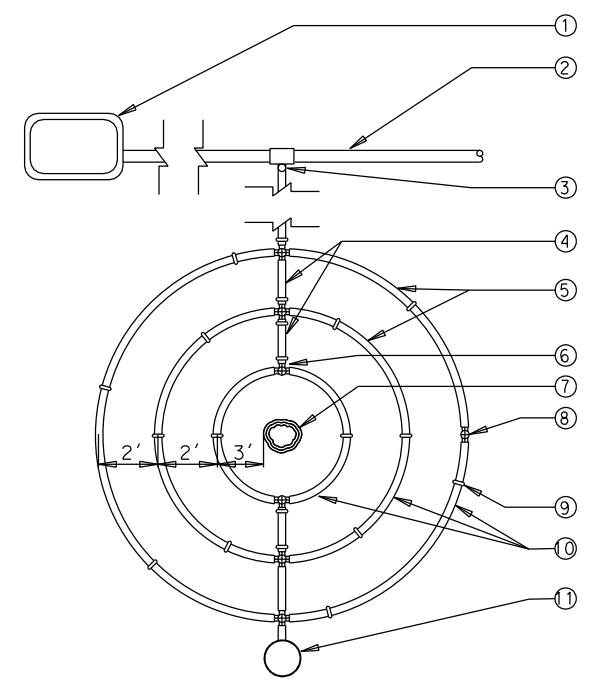

- | | |
|--|--|
| ① DRIP VALVE ASSEMBLY | ⑧ ADAPTER TEE FROM PVC TO DRIPLINE. |
| ② PVC SUPPLY LINE, CONTINUE TO NEXT TREE | ⑨ 6-INCH SOIL STAPLE (TYP). |
| ③ PVC SUPPLY LINE HEADER | ⑩ LOCATE FIRST DRIPLINE RING 3' FROM TREE TRUNK. LOCATE THE SECOND DRIPLINE RING 2' OUTSIDE THE FIRST RING. LOCATE THE THIRD RING 2' OUTSIDE THE THIRD RING. |
| ④ BLANK TUBING | ⑪ FLUSH VALVE WITH GRAVEL |
| ⑤ DIT WITH 0.5 GPH EMITTER AT 12" O/C | |
| ⑥ DIT TEE (TYP) | |
| ⑦ EXISTING TREE TRUNK | |

DRIP IRRIGATION TUBING WITH IN-LINE DRIP EMITTERS AROUND EXISTING TREES

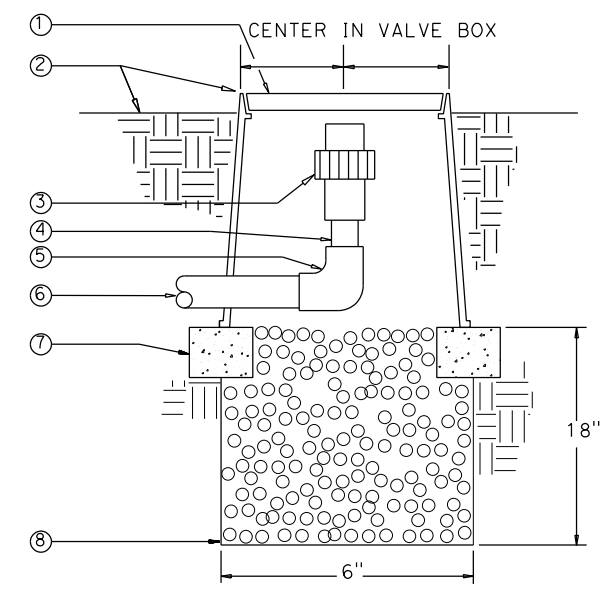

- | | |
|---|------------------------|
| ① 6" ROUND PLASTIC VALVE BOX WITH BOLT DOWN LID | ⑤ SCH 80 PVC ELL |
| ② VALVE BOX TO BE 2" ABOVE FINISH GRADE | ⑥ PVC PIPE |
| ③ 1/2" FLUSH VALVE | ⑦ BRICK SUPPORTS (TWO) |
| ④ PVC SCH 80 NIPPLE | ⑧ PEA GRAVEL SUMP |

FLUSH VALVE

NOTE: LOCATE STAPLES ALONG TUBING AT 4' ON CENTER AND AT ALL FITTINGS (TEES, ELLS, ETC.)

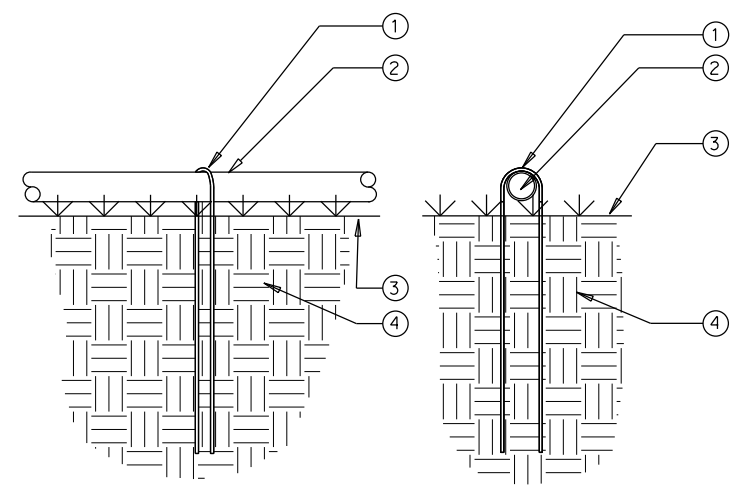

- ELEVATION NOT TO SCALE
- SECTION NOT TO SCALE
- | |
|--------------------------|
| ① STEEL SOIL STAPLE |
| ② DRIP IRRIGATION TUBING |
| ③ FINISH GRADE |
| ④ NATIVE SOIL |

SOIL STAPLE

IRRIGATION DETAILS
NO SCALE
ID-1

#REQUEST STATE OF CALIFORNIA - DEPARTMENT OF TRANSPORTATION
 SIMON KENNEY
 LEAH HAYGOOD
 BEN RAZEGHI
 CALTRANS

LAST REVISION DATE PLOTTED => 4/17/2020 10:38:35 AM
 07-20-16 TIME PLOTTED => 10:38:35 AM

STATE OF CALIFORNIA - DEPARTMENT OF TRANSPORTATION
 #REQUEST
 LANCE BLANCHARD
 CHRIS MITCHELL
 CALCULATED-DESIGNED BY
 CHECKED BY
 CONSULTANT FUNCTIONAL SUPERVISOR
 BEN RAZEGHI

| | | | | | |
|------|--------|--------|-----------------------------|--------------|-----------------|
| Dist | COUNTY | ROUTE | POST MILES TOTAL PROJECT | SHEET No. | TOTAL SHEETS |
| 04 | Ala | 84,680 | 17.9/R22.9 R10.3/R15.3 | | |

 LICENSED LANDSCAPE ARCHITECT

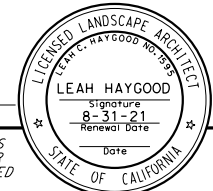

PLANS APPROVAL DATE _____

THE STATE OF CALIFORNIA OR ITS OFFICERS OR AGENTS SHALL NOT BE RESPONSIBLE FOR THE ACCURACY OR COMPLETENESS OF SCANNED COPIES OF THIS PLAN SHEET.

HAYGOOD AND ASSOCIATES ALAMEDA CTC
 1496-B Solano Avenue 1111 Broadway
 Albany, CA 94706 Suite 800
 Oakland, CA 94607

IRRIGATION QUANTITY (LATERAL SUPPLY SIDE OF CONTROL VALVE)

| LOCATION | CONTROLLER LETTER | VALVE NUMBER | PLASTIC PIPE (SCHEDULE 40) (SUPPLY LINE) | | | | DRIP IRRIGATION TUBING | FLUSH VALVE | SPRINKLER ASSEMBLY | | |
|--------------------|-------------------|--------------|--|------|--------|--------|------------------------|-------------|----------------------|----------------|--------|
| | | | 3/4" | 1" | 1 1/4" | 1 1/2" | | | POP-UP (GEAR DRIVEN) | RISER (TYPE V) | POP-UP |
| | | | LF | LF | LF | LF | | | EA | EA | EA |
| IP-1 | P | 1 | 330 | 50 | 25 | | | | | 67 | |
| | | 2 | 250 | 35 | 10 | 60 | | | | | 24 |
| | | 3 | 310 | 125 | | | 950 | 10 | | | |
| | | 4 | 390 | 20 | 10 | | | | | 26 | |
| | | 5 | 250 | 45 | 30 | | | | | | 29 |
| | | 6 | 245 | 45 | 25 | | | | | | 29 |
| | | 7 | 50 | 40 | 80 | 75 | | | 10 | | |
| | | 8 | 190 | 70 | | | | | | 16 | |
| | | 9 | 130 | 50 | 65 | 35 | | | 9 | | |
| | | 10 | 50 | 55 | 75 | 20 | | | 8 | | |
| | | 11 | 330 | 120 | 10 | 10 | | | | | 48 |
| IP-2 TO IP-4 | BAT | 1 | 220 | 140 | 140 | 40 | | | | 44 | |
| | | 2 | 240 | 280 | 160 | 40 | | | | 60 | |
| | | 3 | 220 | 260 | 40 | 40 | | | | 48 | |
| | | 4 | 600 | 160 | 60 | | | | | 28 | |
| | | 5 | 200 | 140 | 180 | 40 | | | | 48 | |
| | | 6 | 220 | 280 | 240 | 40 | | | | 58 | |
| | | 7 | 220 | 240 | 80 | 40 | | | | 50 | |
| | | 8 | 220 | 240 | 60 | 40 | | | | 48 | |
| | | 9 | 220 | 240 | 40 | 40 | | | | 56 | |
| | | 10 | 200 | 240 | 40 | 40 | | | | 56 | |
| | | 11 | 220 | 240 | 40 | 40 | | | | 56 | |
| | | 12 | 220 | 260 | 40 | 40 | | | | 56 | |
| TOTAL | | | 5525 | 3375 | 1450 | 640 | 950 | 10 | 27 | 717 | 130 |

LAST REVISION | DATE PLOTTED => 6/9/2020
 07-20-16 | TIME PLOTTED => 10:49:13 AM

STATE OF CALIFORNIA - DEPARTMENT OF TRANSPORTATION
Caltrans
 CONSULTANT FUNCTIONAL SUPERVISOR: BEN RAZEGHI
 CALCULATED/DESIGNED BY: LANCE BLANCHARD
 CHECKED BY: CHRIS MITCHELL
 REVISED BY: []
 DATE REVISED: []

| | | | | | |
|------|--------|--------|---------------------------|-----------|--------------|
| Dist | COUNTY | ROUTE | POST MILES TOTAL PROJECT | SHEET No. | TOTAL SHEETS |
| 04 | Ala | 84,680 | 17.9/R22.9 R10.3/R15.3 | | |

Leah Haygood
 LICENSED LANDSCAPE ARCHITECT

PLANS APPROVAL DATE: _____

LEAH HAYGOOD
 Signature: _____
 8-31-21
 Renewal Date: _____
 Date: _____
 STATE OF CALIFORNIA

THE STATE OF CALIFORNIA OR ITS OFFICERS OR AGENTS SHALL NOT BE RESPONSIBLE FOR THE ACCURACY OR COMPLETENESS OF SCANNED COPIES OF THIS PLAN SHEET.

HAYGOOD AND ASSOCIATES | ALAMEDA CTC
 1496-B Solano Avenue | 1111 Broadway
 Albany, CA 94706 | Suite 800
 Oakland, CA 94607

IRRIGATION QUANTITY (MAIN SUPPLY SIDE OF CONTROL VALVE)

| SHEET No. | IRRIGATION CONTROLLER | | FLOW SENSOR | WYE STRAINER ASSEMBLY | VALVES AND ASSEMBLIES | | | | | | | | PLASTIC PIPE (SUPPLY LINE) (SCH 40) | HIGH DENSITY POLY ETHYLENE (DR11) | FLOW SENSOR CABLE/CONDUIT | CONTROL AND NEUTRAL CONDUCTORS (ARMOR-CLAD) |
|--------------|--|---------------------------------------|-------------|-----------------------|-----------------------|--------|------|--------|---------------------------|---------------------|----------------|------|-------------------------------------|-----------------------------------|---------------------------|---|
| | 18 STATION (WALL MOUNTED IN ENCLOSURE) | BATTERY POWERED IRRIGATION CONTROLLER | | | REMOTE CONTROL VALVE | | BALL | GATE | PRESSURE REGULATING VALVE | DRIP VALVE ASSEMBLY | QUICK COUPLING | | | | | |
| | EA | EA | | | 1" | 1 1/2" | 2" | 1 1/2" | 2" | 2" | 1" | 3/4" | | | | |
| IP-1 | 1 | | 1 | 3 | 5 | 5 | 1 | 3 | 2 | 1 | 1 | 3 | 520 | | 400 | 1,800 |
| IP-2 | | 2 | | 1 | | 2 | | 1 | | | | 1 | | 680 | | |
| IP-3 | | 6 | | 3 | 1 | 5 | | 3 | | | | 3 | | 1700 | | |
| IP-4 | | 4 | | 2 | | 4 | | 2 | | | | 2 | | 1140 | | |
| TOTAL | 1 | 12 | 1 | 9 | 6 | 16 | 1 | 9 | 2 | 1 | 1 | 9 | 520 | 3520 | 400 | 1,800 |

IRRIGATION QUANTITIES
IQ-2

LAST REVISION | DATE PLOTTED => 6/9/2020 | 07-20-16 | TIME PLOTTED => 10:49:13 AM